

# WELD-ON SHOULDERS

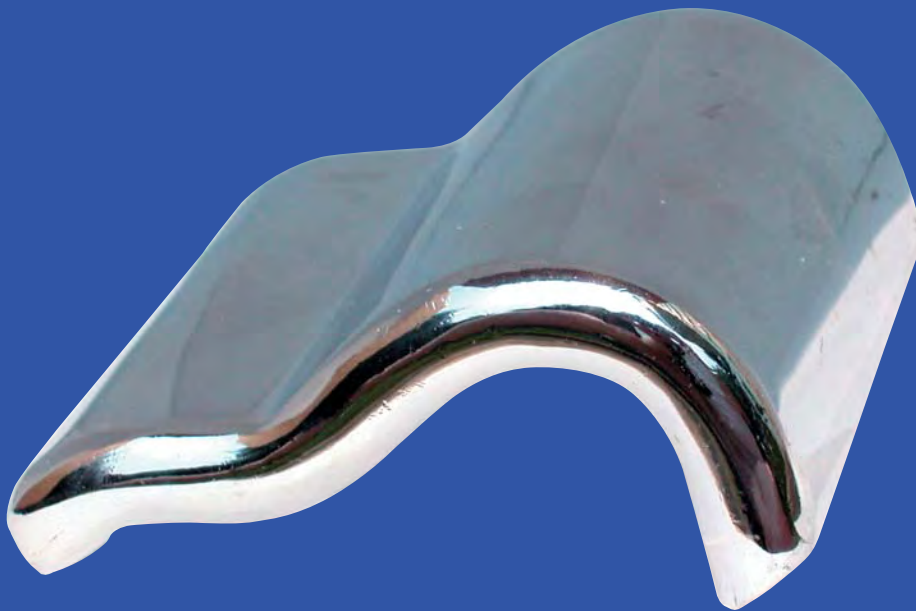

Pandrol Weld-On Shoulders are designed to be used in special trackwork locations that do not permit the use of the standard Pandrol tie plate. Switches, scales, steel structures and maintenance facilities are just some of the applications of this steel shoulder. Generally used on a flat steel plate, these shoulders are beveled to facilitate welding. Weld-On Shoulders are designed to provide optimum lateral resistance and maximum clip toe load.

Weld-On Shoulders can be designed for all rail sizes and are readily available in the commonly used standard rail sizes.

 **PANDROL**

TRACK SYSTEMS

© DELACHAUX GROUP

## PRESSED STEEL WELD-ON SHOULDER SPECIFICATIONS:

- Made from low carbon steel
- Approximate shipping weight: 1.5 lbs.
- Normally packed 50 per bag

| PART NO.   | RAIL SIZE                       |
|------------|---------------------------------|
| WOS-2172-1 | 115 -141 RE                     |
| WOS-2172-2 | 100 RB                          |
| WOS-2172-5 | 115 -141 RE, 1/4" Pocket        |
| WOS-2172-6 | 100 RB, 1/4" Pocket             |
| WOS-7824   | Insulated Assemblies - 10mm pad |

\* Designs available for virtually all rail sizes

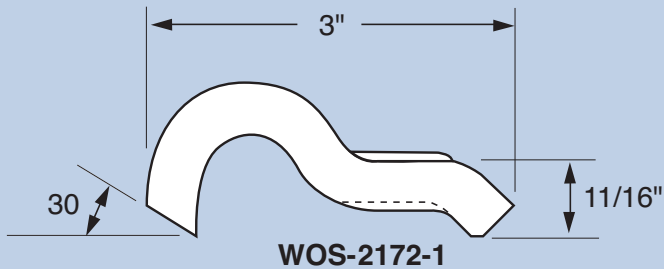

## WELD-ON SHOULDER STANDARD ASSEMBLY

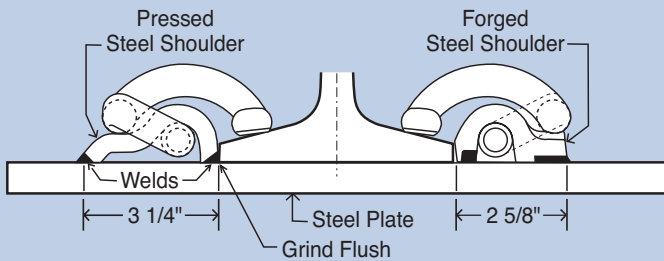

## FORGED STEEL WELD-ON SHOULDER SPECIFICATIONS:

- Made from low carbon steel
- Approximate shipping weight: 1.7 lbs.
- Normally packed 50 per bag

| PART NO.   | RAIL SIZE    |
|------------|--------------|
| SHL-7299-1 | 115 - 141 RE |

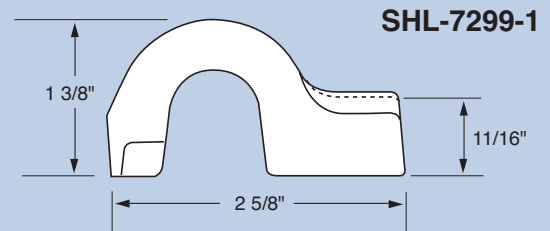
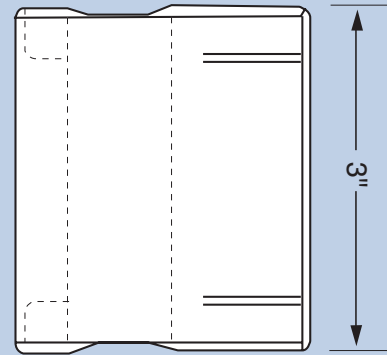

## WELD-ON SHOULDER INSULATED ASSEMBLY

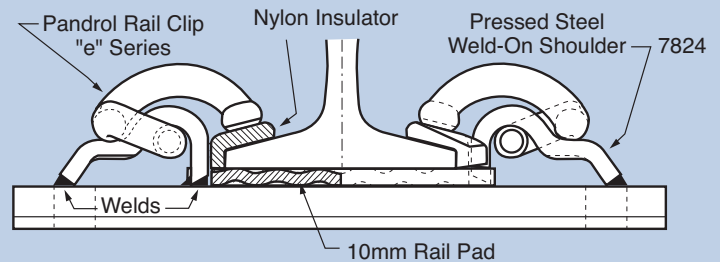

**PANDROL**  
CANADA

© DELACHAUX GROUP

Pandrol Canada Limited  
6910 34th Street  
Edmonton, Alberta T6B 2X2, Canada

(780) 413-4281

[www.pandrolcanada.ca](http://www.pandrolcanada.ca)

Pandrol's weld-on shoulder is protected by U.S. and foreign patents.

*In the interests of product improvement, Pandrol reserves the right to change the specifications contained herein at any time without prior notice.*

6/10 .5M

**PANDROL**  
USA

© DELACHAUX GROUP

Pandrol USA, LP  
501 Sharptown Road  
P.O. Box 367  
Bridgeport, NJ 08014  
(856) 467-3227  
(800) 221-CLIP

[www.pandrolusa.com](http://www.pandrolusa.com)